

Strobe Light

Part No.: SLX-123N



The Ingram SLX-123N is an adjustable low cost strobe light suitable for heavy duty applications inside and outdoors. It can be set by the user for three intensity levels: low, medium and high. The lens is molded from tough shatter resistant GE Lexan. This tamper resistant strobe is particularly useful in areas with high ambient noise levels where an audible signal may not be heard.

The SLX-123N strobe requires a DC power source. Ingram's BB-12 back-up battery with charger is suggested.

Features

- Lens molded from GE Lexan that is shatter resistant and UV stabilized
- Low profile, top mounted gives 360 degree visibility
- Hose down proof
- Available in 5 colors: Red, Blue, Green, Amber and Clear

Technical Specifications

- Voltage: 12 or 24 VDC
- Current Draw: 115 mA \pm 20%
- 140 mA Max
- Supplied with Xenon Flash Tube and circuit board
Requires DC power source
Wire leads measure at least 6" from grommet

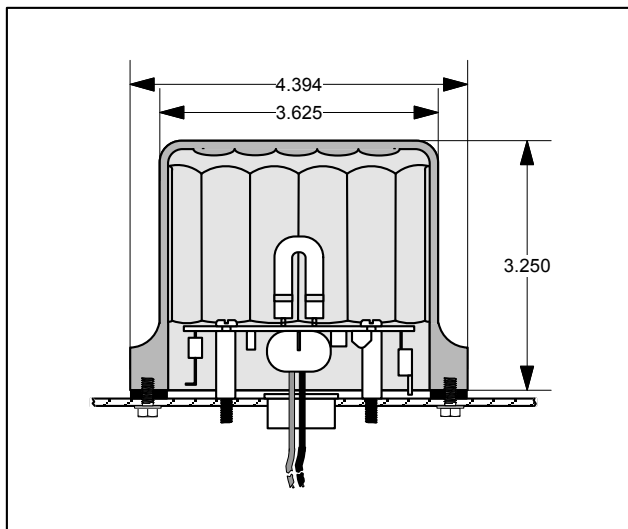

Cut-Away View

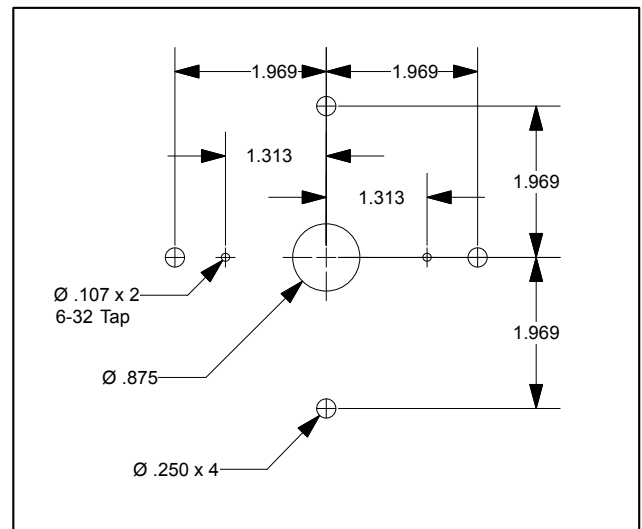

Hole Pattern For Mounting

Shatter Resistant
G.E. Lexan Globe

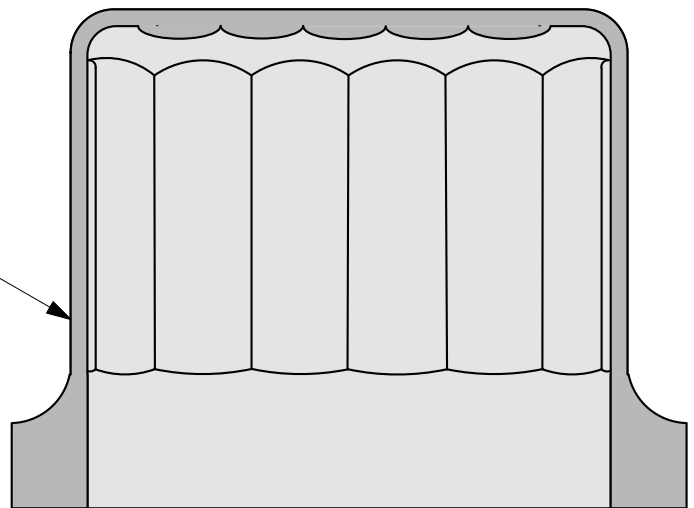

Gasket



Zenon Flash Tube
Assembly

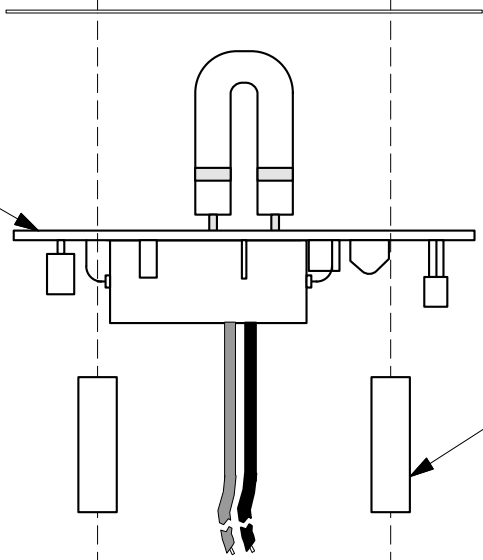

Standoff

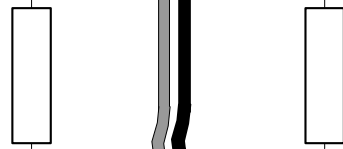

1/2" Grommet

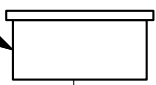

Enclosure Wall

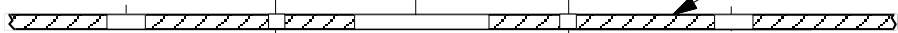

#8-32 Mounting
Screw



SLX-123N Assembly